

DOUBLE SKIN STEEL PARTITIONING

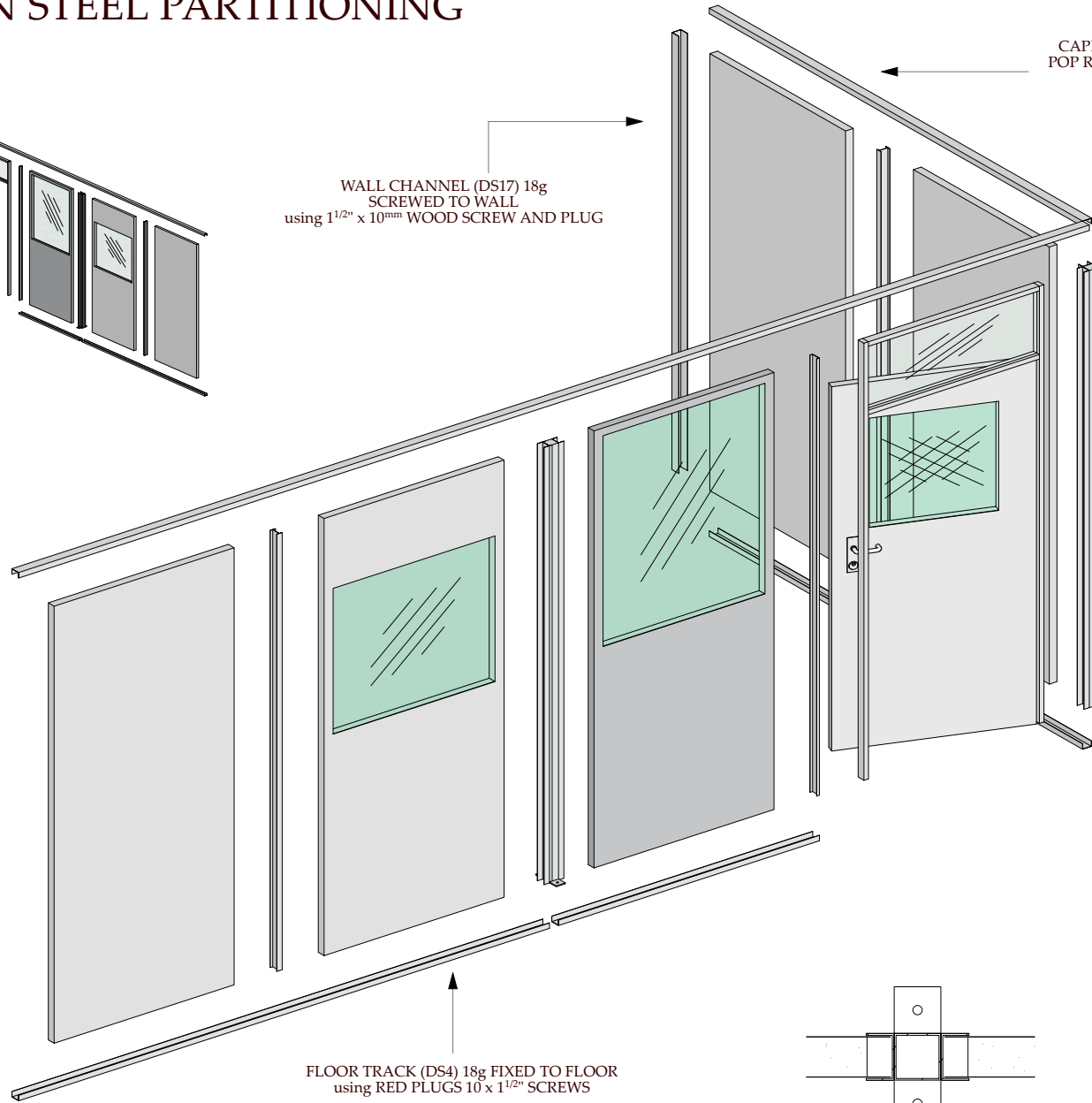
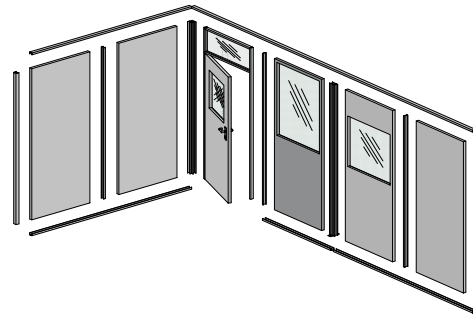

WALL CHANNEL (DS17) 18g
SCREWED TO WALL
using 1 1/2" x 10mm WOOD SCREW AND PLUG

CAPPING (DS4) 18g
POP RIVET TO PANEL

FLOOR TRACK (DS4) 18g FIXED TO FLOOR
using RED PLUGS 10 x 1 1/2" SCREWS

DS17
WALL CHANNEL

DS5
UPRIGHT

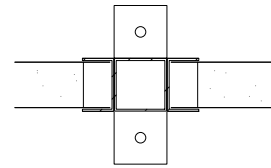

TWO WAY MULLION
(inter)

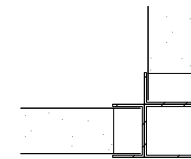

TWO WAY MULLION
(corner)

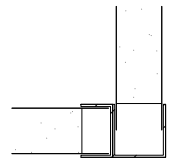

DS4/17
CORNER SECTION
(OPTION)