

# DOUBLE SKIN STEEL PARTITIONING

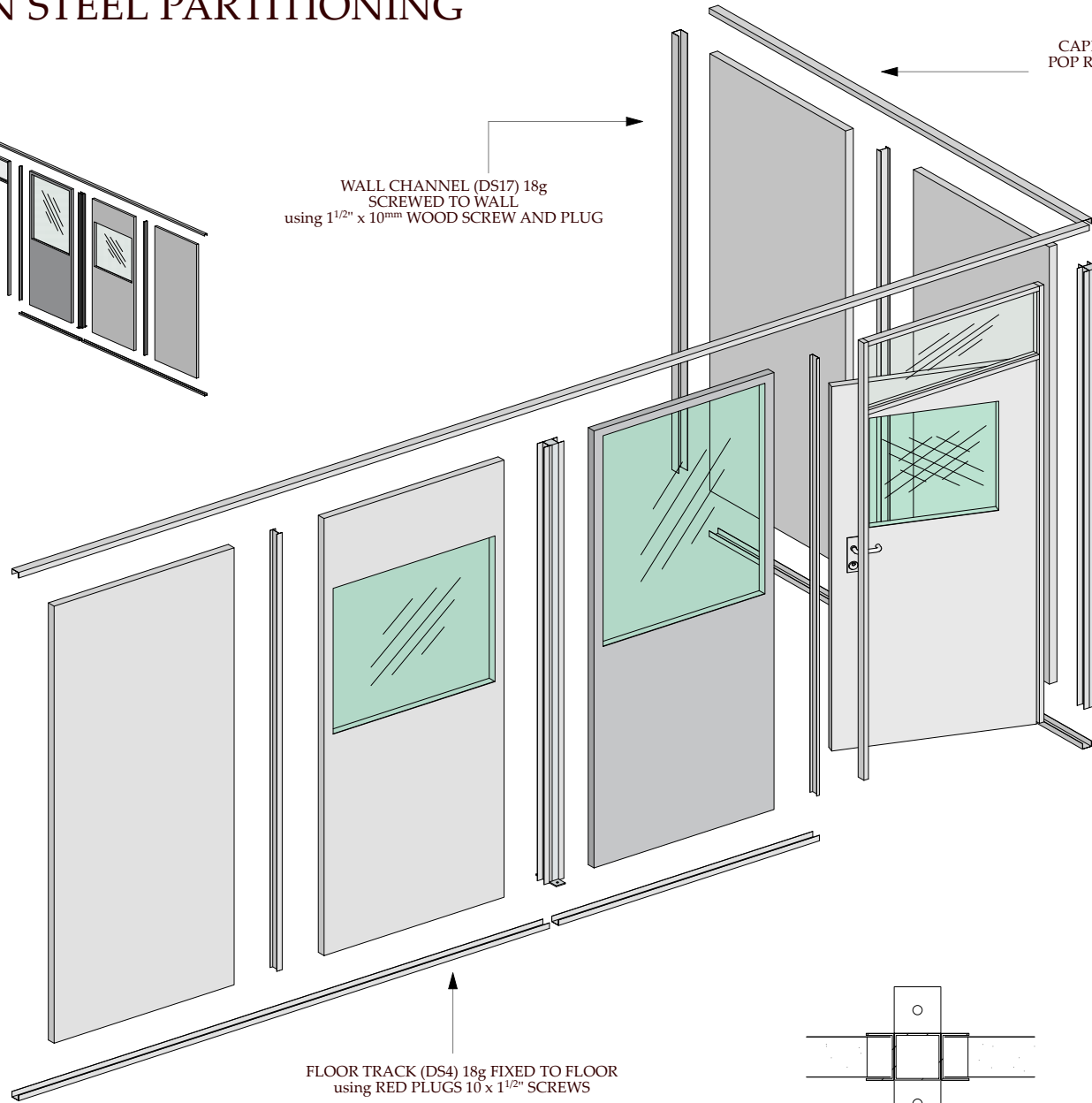
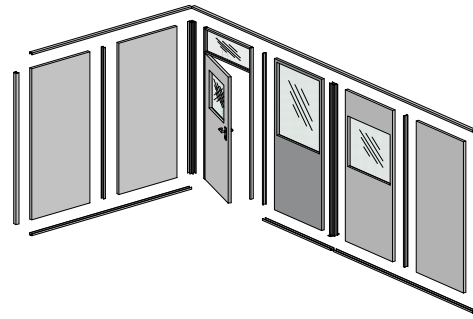

WALL CHANNEL (DS17) 18g  
SCREWED TO WALL  
using 1 1/2" x 10mm WOOD SCREW AND PLUG

CAPPING (DS4) 18g  
POP RIVET TO PANEL

FLOOR TRACK (DS4) 18g FIXED TO FLOOR  
using RED PLUGS 10 x 1 1/2" SCREWS

DS17  
WALL CHANNEL

DS5  
UPRIGHT

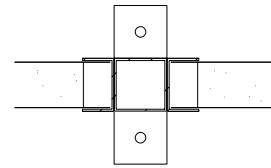

TWO WAY MULLION  
(inter)

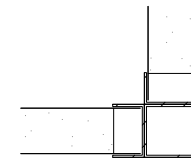

TWO WAY MULLION  
(corner)

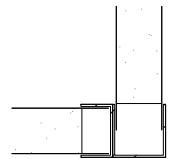

DS4/17  
CORNER SECTION  
(OPTION)